

7 Days winter HOKKAIDO



Package Include

- ✓ 5&4 Star Hotel Room
- ✓ Daily Breakfast
- ✓ Private Transport
- ✓ Destination Tickets
- ✓ Tour Companion



Special Offer

Book at least 6 months
prior to your trip

10% Price off
/person

Contact Us

+62 811 518 518 www.tourjapan.jp @tourjapanofficial

TABLE OF CONTENT

HIGHLIGHTS

Explore Hokkaido the most beautiful island of japan

ACCOMMODATION

You will stay at a 5-star hotel in Niseko

ITINERARY

Private trips designed especially for you

PRICE PER PERSON

Get an early discount of up to 10%

FAQ

Frequently asked questions

CONTACT US

Please don't hesitate to contact our travel consultant.



Our specially curated 7 days winter tour to Hokkaido Niseko invites you to indulge in the winter activities of your dreams, whether you're a seasoned ski enthusiast or a winter admirer



Tour highlights

Exploring the snowy paradise of Niseko, Japan

Visit popular destination in Hokkaido in winter

Completely private tours tailored just for you

Visit Sapporo, Asahikawa, Furano, and Hakodate

Enjoy a 2-night stay at Hilton Niseko Village, where comfort meets luxury amidst snowy peaks



Accommodation

Day 1-3



Mercure Sapporo



Day 3-5



Hilton Niseko



Day 5-6



Hakodate Kokusai Hotel



Day 6-7



Toya Nonokaze Resort



**If the hotel rooms are fully booked, they will be replaced with another equivalent hotel.

Note: You can update to Luxury hotels like Zaborin Ryokan, Park Hyatt Niseko, Ritz-Carlton Niseko, or Chalet Ivy Jozankei with an additional fee.

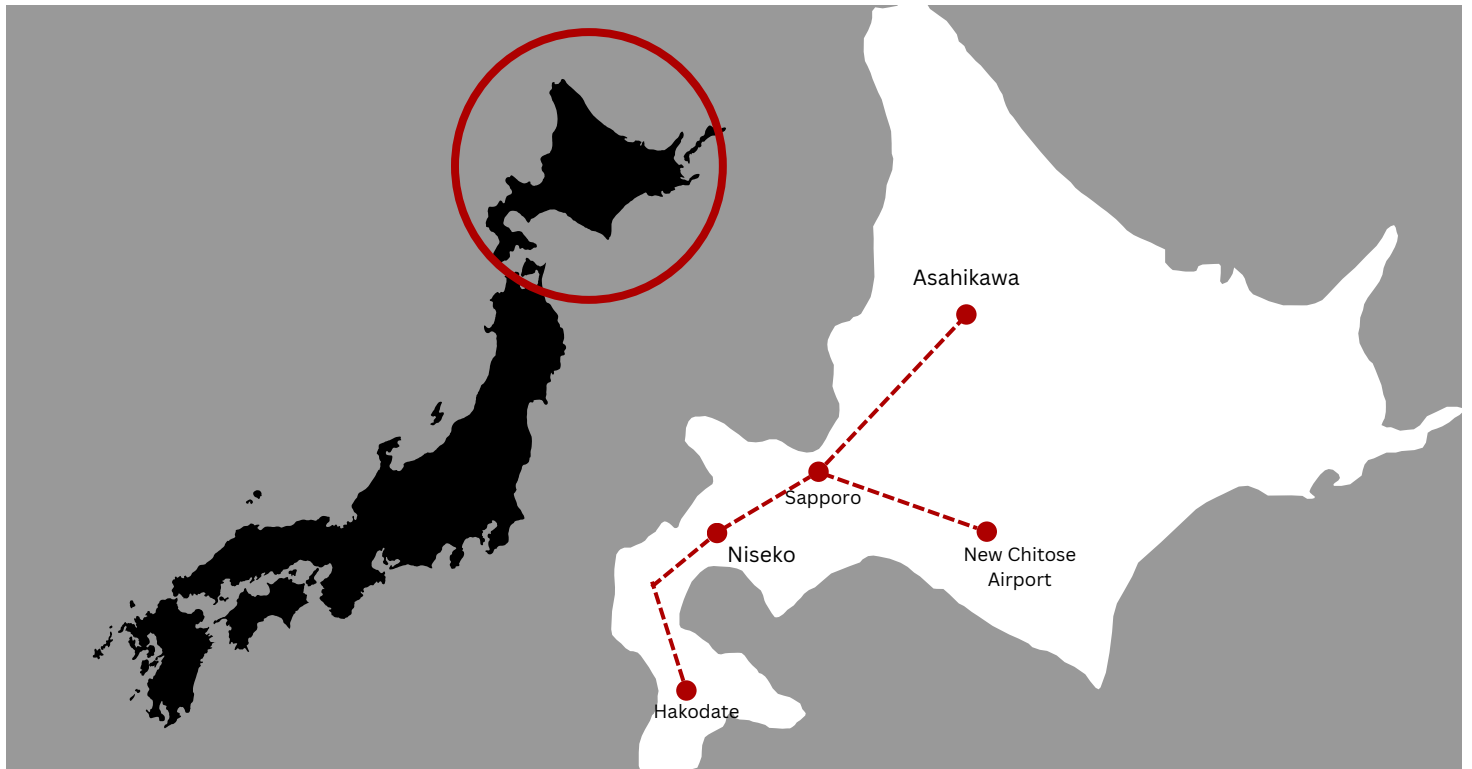

Itinerary

Day 1: CTS-Sapporo
Day 2: Asahikawa-Furano
Day 3: Otaru-Niseko
Day 4: Niseko
Day 5: Hakodate
Day 6: Lake Toya
Day 7: Airport transfer to CTS



Itinerary

Day1: CTS-Sapporo

Transport: Alphard or Hiace
Guide: Travel Companion
Hotel: Mercure Sapporo****/similar
Meal: No Meal

Day2: Asahikawa-Furano

Transport: Alphard or Hiace
Guide: Travel Companion
Hotel: Mercure Sapporo****/similar
Meal: Breakfast, X, X

Day3: Otaru-Niseko

Transport: Alphard or Hiace
Guide: Travel Companion
Hotel: Hilton Niseko*****/similar
Meal: Breakfast, X, X

Day4: Niseko

Transport: Alphard or Hiace
Guide: Travel Companion
Hotel: Hilton Niseko*****/similar
Meal: Breakfast, X, X

Day5: Hakodate

Transport: Alphard or Hiace
Guide: Travel Companion
Hotel: Hakodate Kokusai Hotel****/similar
Meal: Breakfast, X, X

Day6: Lake Toya

Transport: Alphard or Hiace
Guide: Travel Companion
Hotel: Toya Nonokaze Resort****/similar
Meal: Breakfast, X, X

Day7: Airport Transfer to CTS

Transport: Alphard/Hiace
Guide: No Guide Service
Hotel: Hilton Tokyo Shinjuku*****/similar
Meal: Breakfast, X, X

Additional info:

- We can customize this itinerary based on your interest.
- We can change the route based on hotel availability and weather conditions.



Day 1: Arrive in Hokkaido

Transport: Toyota Alphard or Hiace
Tour Companion: Indonesian
Meal: X, X, X

Schedule

10:00 Pick up at New-Chitose Airport
11:00 Transfer to Sapporo
12:00 Sapporo
12:30 Lunch
14:00 Hokkaido Jingu
16:00 Odori Park
17:30 Hotel check-in
18:00 Rest at the hotel

Transfer to Sapporo

On the first day, our team will pick you up at the airport and assist you with preparations for the tour. A private coach will take you to your hotel in the city's heart.

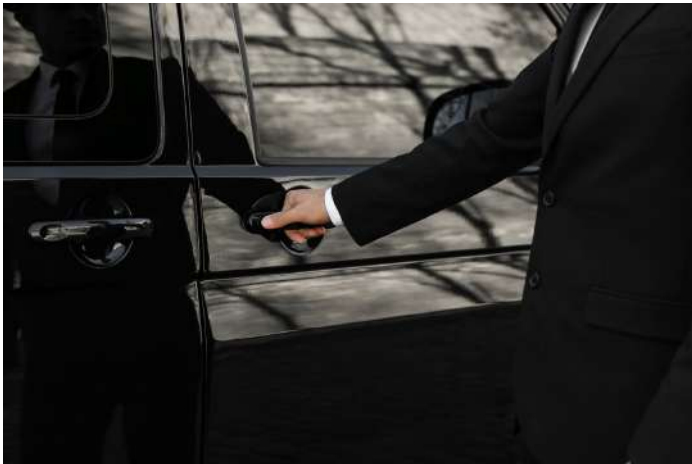

Airport transfer by private car



Mercure Sapporo/Similar



Hokkaido Jingu



During winter, Hokkaido Jingu transforms into a winter wonderland, draped in pristine snow. The sacred Shinto shrine, located in Sapporo, takes on a serene, ethereal beauty in the cold season. Visitors can enjoy the tranquil snowscape, adding a layer of majesty to the spiritual experience at this revered site.

Before check in at hotel we will visit Odori Park. Odori Park is Sapporo's central park, renowned for its seasonal beauty, vibrant festivals, and the iconic Sapporo TV Tower.

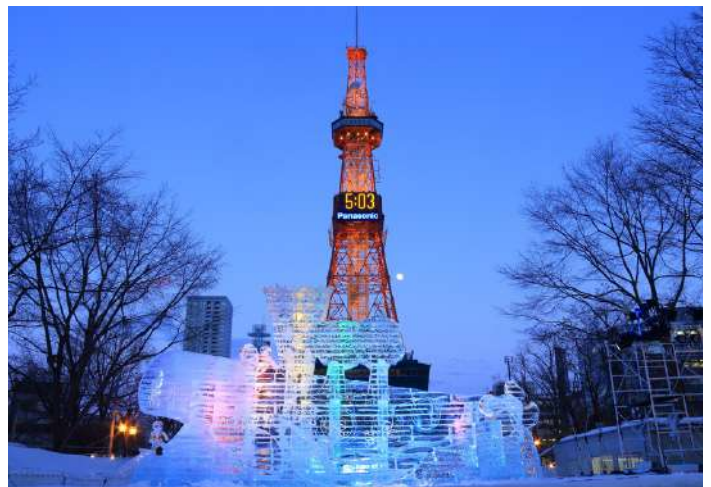

Odori Park

Day 2: Asahikawa-Furano

Transport: Toyota Alphard or Hiace
Tour Companion: Indonesian
Meal: Breakfast, X, X

Schedule

08:00 Pick up at hotel
08:10 Transfer to Asahikawa
10:00 Asahiyama Zoo
12:30 Lunch
14:00 Biei (photo stop)
16:00 Ninggle Terrace
17:00 Depart to Sapporo
19:00 Drop at hotel

Asahiyama Zoo

During winter, Asahiyama Zoo in Hokkaido becomes a snowy spectacle. Renowned for its interactive exhibits, visitors can observe a variety of animals in environments resembling their natural habitats, even in the cold. The highlight is the Penguin Walk, where these charming creatures waddle freely amidst the delighted guests.



Asahiyama Zoo



Mercure Sapporo/Similar



Biei Seven Star Tree



Seven Star Tree

The Seven Stars Tree is an iconic lone oak situated on the picturesque landscape of Biei, Hokkaido. Known for its appearance on a cigarette brand's package, it captivates visitors with its year-round beauty. Its solitary silhouette against the expansive field creates a truly remarkable and photogenic sight.

Ninggle Terrace

With its artisan cottages tucked into the forest and blanketed in snow, Ningle Terrace is a testament to the breathtaking beauty of winter. Its enchanting snow-laden landscape paints a scene straight from a fairy tale, making each visit a warm and magical affair.



Ningle Terrace

Day 3: Otaru-Niseko



Transport: Toyota Alphard or Hiace
Travel Companion: Indonesian
Meal: Breakfast, X, X

Schedule

09:30 Check-out
10:00 Pick up at hotel
10:30 Shiroi Koibito Park
12:00 Depart to Otaru
12:30 Lunch
14:00 Otaru
16:00 Depart to Niseko
18:00 Dinner
20:00 Hotel check in



Shiroikobito Park

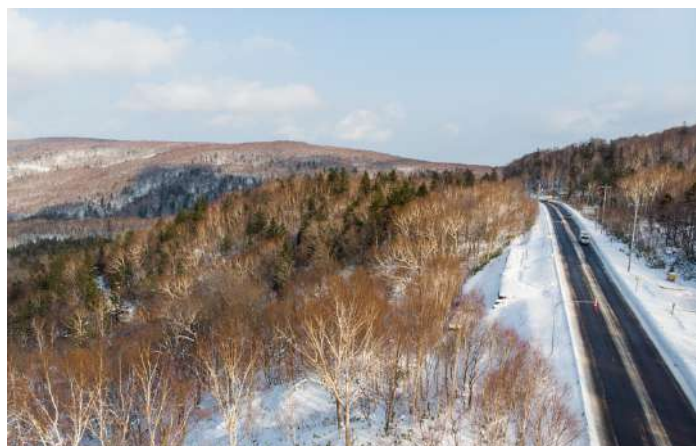

View of a road between Otaru and Niseko during winter



Hilton Niseko Village/Similar



Day 4: Winter Activities (optional)

Experience the thrill of Niseko, the epicenter of winter activities. From exhilarating snowboarding and serene snowshoeing to relaxing in warm onsens, Niseko transforms winter into an adventure-filled escape. Dive into a world of snow, fun, and unforgettable memories.



Snowboarding



Snow Shoeing



Snowmobile



Snow Rafting



Ski Schools



Snowboard Schools

Day 5: Niseko-Hakodate

Discover Hakodate, where history and nature intertwine. From the breathtaking night view atop Mount Hakodate and the vibrant Morning Market's fresh seafood to the historic architecture of Motomachi. Every corner of Hakodate is a journey into culture, beauty, and unforgettable experiences. Experience Hakodate, a hidden gem of Hokkaido.



Transport: Toyota Alphard or Hiace
Travel Companion: Indonesian
Meal: Breakfast, X, X

Schedule

09:30 Check out
10:00 Depart to Hakodate
12:00 Lunch
15:00 Kanemori Red Brick
17:00 Mt Hakodate
18:30 Dinner
19:30 Transfer to hotel
20:00 Hotel check in

Kanemori Red Brick



Kanemori Red Brick Warehouse, a historical gem in Hakodate, offers a unique experience blending culture, shopping, and dining. Its beautifully restored red brick structures house eclectic shops and delicious eateries, attracting visitors worldwide.



Hakodate kokusai hotel/Similar



Day 6: Hakodate-Lake Toya

Transport: Toyota Alphard or Hiace
Tour Companion: Indonesian
Meal: Breakfast, X, X

Schedule

09:00 Pick up at a hotel
09:30 Hakodate Morning Market
12:00 Lunch
13:00 Depart to Lake Toya
15:00 Lake Toya
18:00 Dinner
19:00 Transfer to hotel
19:30 Hotel check-in (finish tour)

Hakodate Morning Market



Fresh alaskan king crab

Hakodate Morning Market is a vibrant hub of fresh seafood and local produce. Open from dawn, it's a must-visit for food lovers seeking to experience Hokkaido's culinary richness and traditional market culture.



Toya Nonokaze Resort/Similar



Lake Toya



Lake Toya

In winter, Lake Toya in Hokkaido transforms into a magical landscape with snow-covered shores. Visitors can enjoy soothing hot springs, stunning snow sculptures, and the tranquil beauty of the frozen lake.

After dinner at Lake Toya area, we will check-in in at one the best hotel in Lake Toya. Lake View Toya Nonokaze Resort, situated on the scenic shores of Lake Toya, offers unrivaled luxury and breathtaking views. With exquisite dining, hot spring baths, and elegant rooms, it promises an unforgettable Hokkaido experience.

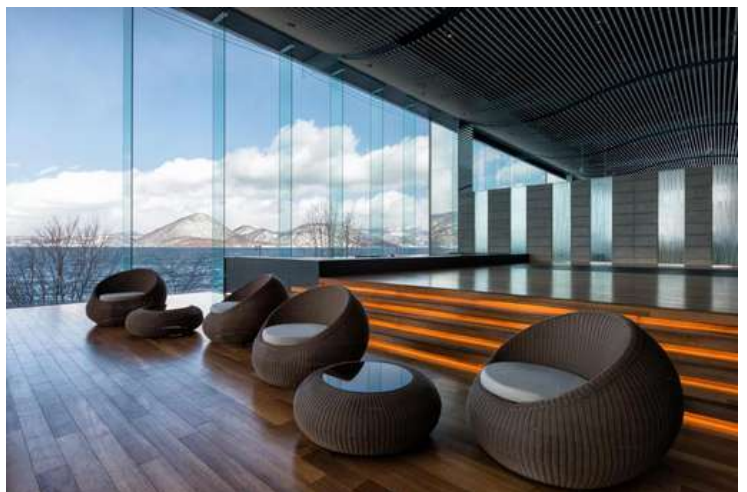

Lake View Toya Nonokaze Resort

Day 7: Airport transfer



Transport: Toyota Alphard or Hiace
Travel Companion: XXX
Meal: X, X, X

Schedule

10:00 Hotel pick up
10:30 Transfer to Airport
12:00 Shinchitose Airport
12:15 Self-check in



Today you have completed the 7 Days Winter Hokkaido Tour. We hope that you enjoyed your trip with TOURJAPAN. On the last day, you will check out of your hotel, and your driver will take you to Shin-Chitose International Airport. Please make a self-check-in. Have a safe flight back home, and see you again on the next trip.

Price per person

Price with 5&4 star hotel

2 Person: JPY 730,000/Pax
3 Persons: JPY 570,000/Pax
4-5 Persons: JPY 480,000/Pax
6-7 Persons: JPY 390,000/Pax
8-9 Persons: JPY 350,000/Pax
10-14 Persons: JPY 330,000/Pax

Price without hotel

2 Person: JPY 600,000/Pax
3 Persons: JPY 450,000/Pax
4-5 Persons: JPY 360,000/Pax
6-7 Persons: JPY 270,000/Pax
8-9 Persons: JPY 230,000/Pax
10-14 Persons: JPY 200,000/Pax

Include

- Tour accommodation (5-star hotel 3 nights, 4-star hotel 3 nights)
- Breakfast
- Private car (Alphard or Hiace)
- Itinerary consultation fee
- Gasoline, fee driver, and toll fee
- Indonesian-speaking travel companion
- Entrance fee

Exclude

- Airlines ticket to Hokkaido
- Japan visa
- Winter activities (optional)
- Lunch & dinner
- Travel Insurance
- High season surcharge 10%

Frequently asked questions about the tour.

Flights

International flights are not included in the tour price and should be independently arranged by the traveler. This particular itinerary starts in Sapporo and ends in Sapporo. Please book a flight to New-Chitose Airport and a flight out of New-Chitose Airport.

Travel companion

An Indonesian-speaking travel companion will accompany you on all days. The travel companion is at your service during the designated tour hours.

Private Car

The driver and car will be available only during the designated tour hours and only for the included destinations. If you want to explore the city after the main tour is finished, your travel companion will accompany you by public transport without an additional fee.

Contact us



0811 518 518



info@tourjapan.jp



tourjapan.jp



@tourjapanofficial

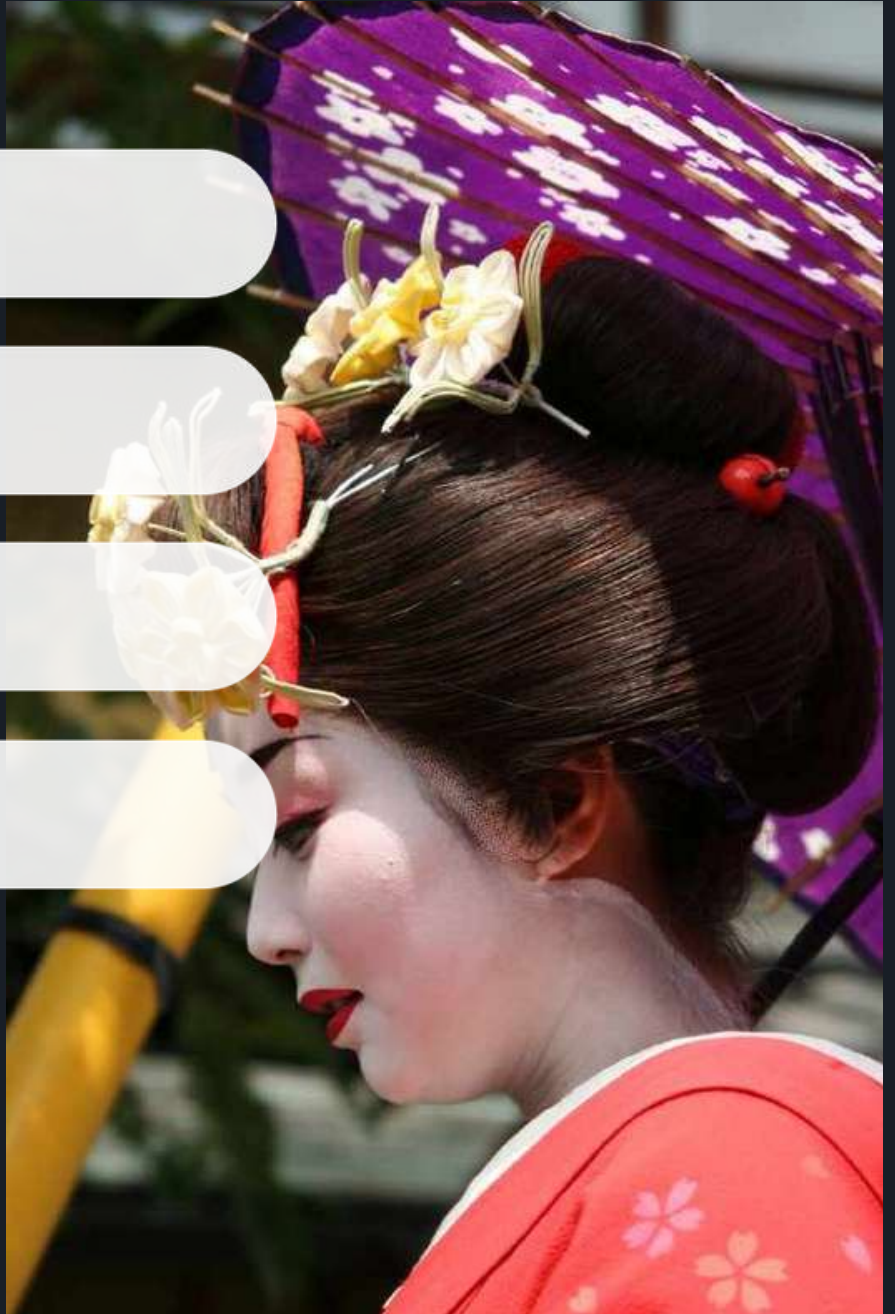

[View all packages](#)